

PLAYGROUND NEWS

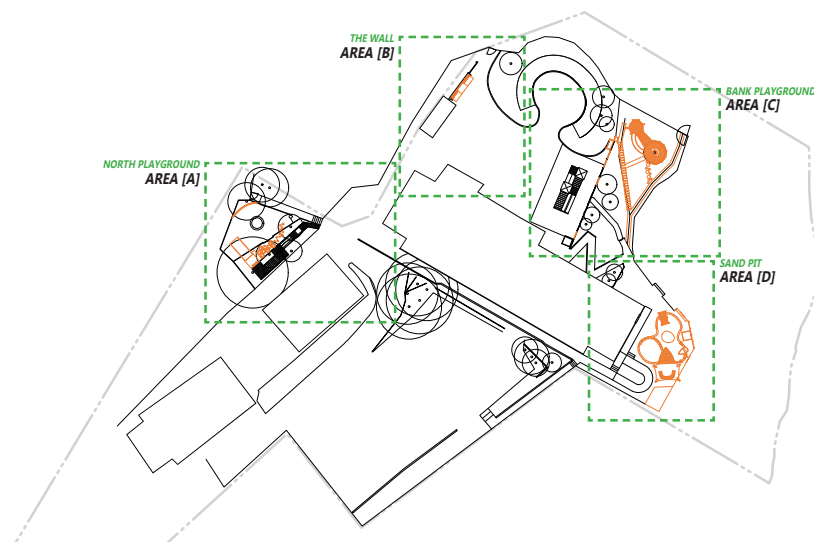

With the school year drawing to a close the Board of Trustees and the Playground Committee thought we would give the school community an in-depth update as to where we are at with our playground development.

We are working with Aspen Landscapes who have provided us with a great design spread over four areas of the school, for a total cost of around \$90,000. With the wonderful fundraising led by our hard working Friends committee, we are pleased to say that we are in a position to implement Areas A and C, and building work on these will commence in January 2019. Once we raise enough money we will move on to Area B, and then finish up with Area D.



“Building work is to start in January 2019”

We are extraordinarily grateful to the Friends of Roseneath School who work tirelessly to organise great events for our school community. The Friends aim to raise around \$15,000 a year, and with your support they have raised all of the \$45,000 cost of this first stage of work. We've listed the "big ticket" items under each area so you can see where the money is going.

"Thank you for your support"

We have also been incredibly fortunate to have received donations from two families that are the equivalent of almost two years of

fundraising. These amazing donations have been used to purchase the SuperNova and have also ensured that we will be able to implement Area B later in 2019.

To complete the rest of the project we envisage that we will need another two years of fundraising from the school community but in the meantime we are keeping a keen eye out for sponsorship or other opportunities to speed up progress.

This whole project started with parent support and we really appreciate all you are doing to get us over the line. The new playground areas are going to look amazing and we are very excited that soon we'll have something tangible to show for your efforts!

Ngā mihi,

Board of Trustees & the Playground Committee

Area A: Old adventure

Area A is the Old Adventure Playground near to the school hall. We already have the Supernova installed which was donated by a school family and has been a massive hit with the kids. A new deck area is being added here to accommodate a lovely double-width slide



Slide \$2,750

Slide with installation \$4,848

Deck \$5,076

Area B: Climbing wall

Area B is the area right next to the PE sheds. The plan is to erect a climbing wall and net, with safety matting (PlayMatta) on the ground underneath.

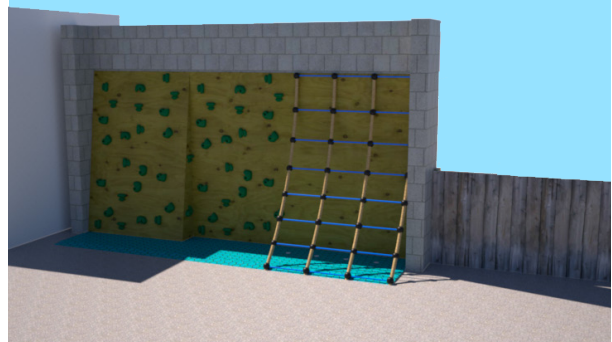

Playmatta \$4624

Climbing holds \$992

Area C: Crows nests

Area C is the currently under-utilised area on the bank by our north eastern border. To make the most of the amazing outlook over the water (and to fit in with our nautical theme) 2 crows-nest viewing decks are being built that will have a cargo net and a slide linking them.



Big deck \$10,413
 Small deck \$6,705
 Stepping posts \$3,590
 Cargo net \$8,222
 Slide \$4000
 Macrocarpa steps \$8,645
 Telescope \$1500

Area D: Sand pit

Area D is where our sandpit currently is and will be turned into a full nautical area with a deck jetty, dry pond, shade sail, sand pit and a beached dinghy for good measure. We feel this is a fairly under-utilised area at present and will become a really fun area for the kids to play.

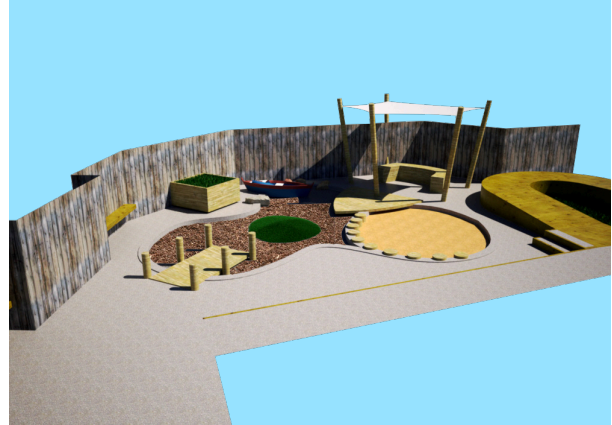

Bow deck and built in seating \$5,193
 Deck jetty \$3,459
 Crushed lime \$2,607
 Dry pond edge \$2,362
 Bedding sand \$1,696
 Stepping posts \$3,590



